

Sugar Maple

COMMUNITY
Hills At Valley View

PRICED FROM
\$340,990



**3
Beds**



**2 -
3.5
Baths**



**2-Car
Garage**



1,328

-

**1,944
Sq. Ft.**

This 3-bedroom, 2-bath, one-story Sugar Maple is a beauty! You'll enjoy an open floorplan with a spacious family room that opens to a well-appointed kitchen with an eat-at-island. Two additional bedrooms and a primary suite boasting a sizeable bathroom and walk-in closet round out this impressive floorplan. Don't forget to finish the basement to add even more space for entertaining or relaxing with the family.



Have Questions? Ask...

KELLY

(484) 772-2693 / bhmarketing@berkshomes.com





Have Questions? Ask...

KELLY

(484) 772-2693 / bhmarketing@berkshomes.com



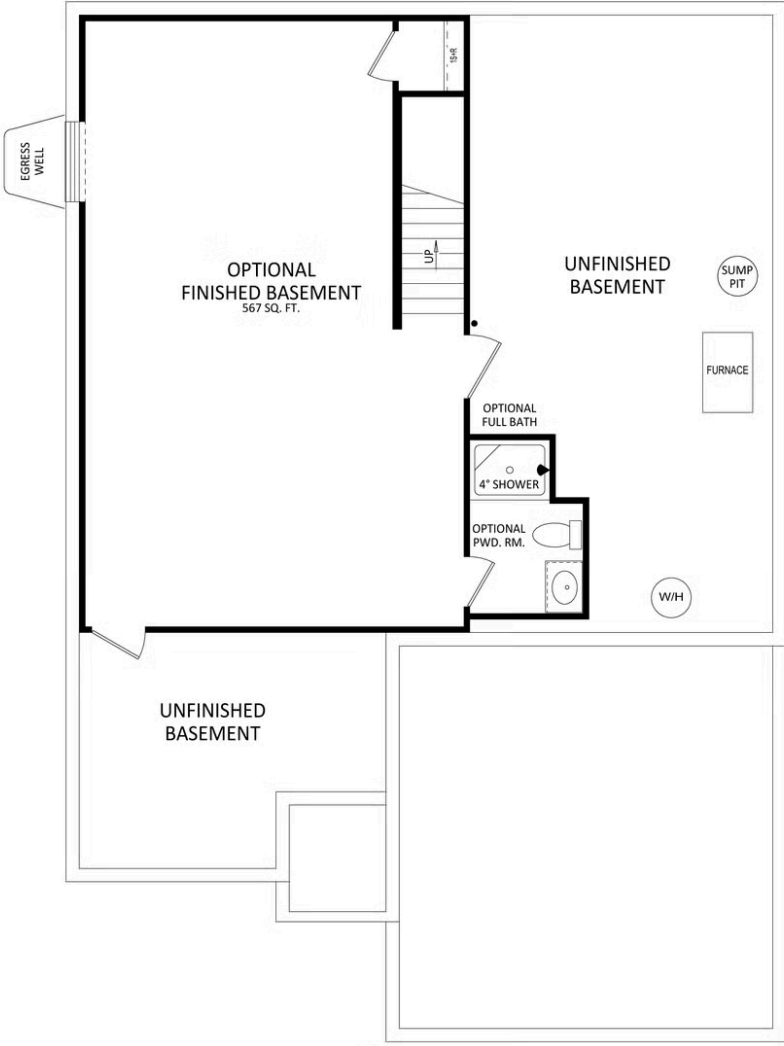

LOWER LEVEL



Have Questions? Ask...

KELLY

(484) 772-2693 / bhmarketing@berkshomes.com

