

# 3535 Pebble Run Drive LOT 52

\$449,990

UNDER CONSTRUCTION

FLOORPLAN  
**Black Cherry**  
COMMUNITY  
**The Seasons**



4  
Beds



2.5  
Baths



2-Car  
Garage



2522  
Sq. Ft.



REPRESENTATIVE PHOTO



REPRESENTATIVE PHOTO

This thoughtfully designed two-story home offers space, style, and functionality with upgrades throughout.

The main level opens with a welcoming foyer that flows into the heart of the home. The upgraded kitchen features a center island, granite countertops, tile backsplash, upgraded cabinetry, stainless steel appliances, and recessed lighting. The adjacent breakfast area connects seamlessly to the morning room addition — a sun-filled space perfect for a quiet cup of coffee or casual dining. Step outside to the 10x12 composite deck, ideal for relaxing or entertaining. The kitchen and breakfast area flow into the spacious family room, enhanced with upgraded windows and recessed lighting. Engineered vinyl plank flooring runs throughout the first-floor living areas for a clean, cohesive look that's built t...

## Dover Area School District

### Sales Office Hours

By Appointment: Wednesday - Saturday 10:00 am - 5:00 pm |  
Closed Sundays, Mondays, and Tuesdays



Have Questions? Ask...  
**KELLY**

(484) 772-2693 / bhmarketing@berkshomes.com





FIRST LEVEL



**Have Questions? Ask...**  
**KELLY**

(484) 772-2693 / [bhmarketing@berkshomes.com](mailto:bhmarketing@berkshomes.com)





SECOND LEVEL



**Have Questions? Ask...**  
**KELLY**

(484) 772-2693 / [bhmarketing@berkshomes.com](mailto:bhmarketing@berkshomes.com)



# 3535 Pebble Run Drive LOT 52

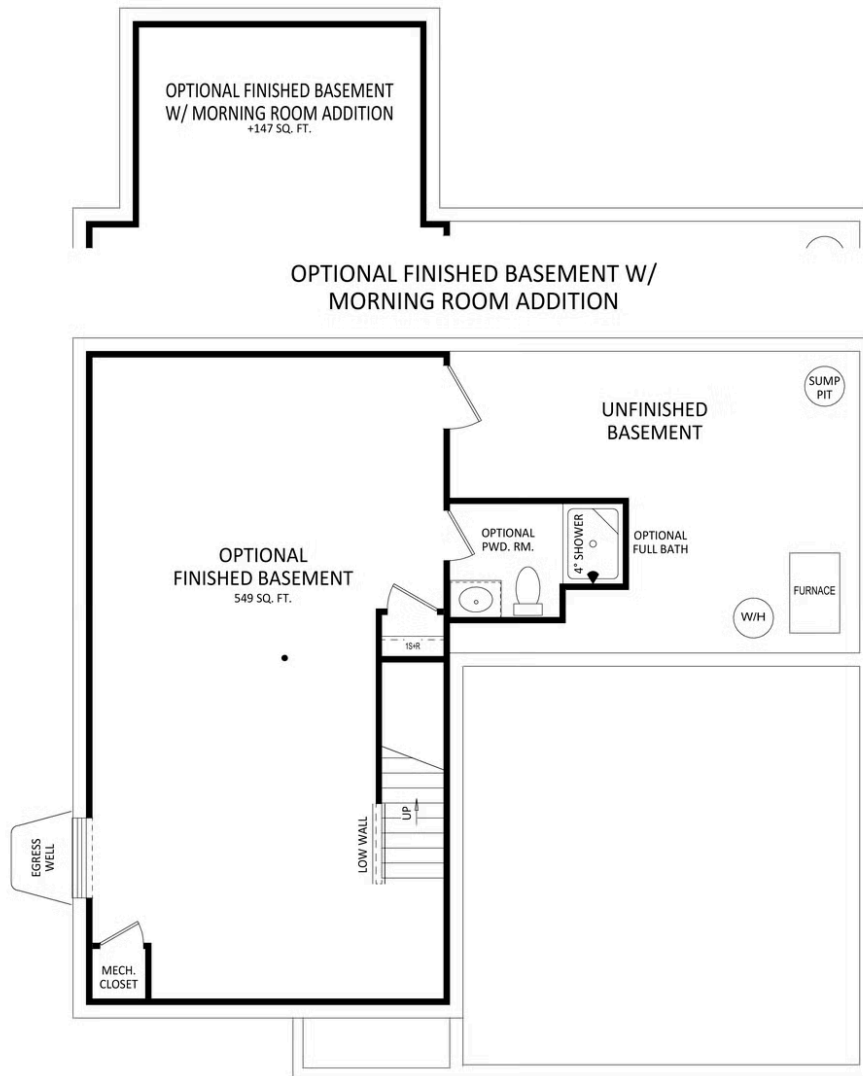

LOWER LEVEL



**Have Questions? Ask...**  
**KELLY**

(484) 772-2693 / [bhmarketing@berkshomes.com](mailto:bhmarketing@berkshomes.com)

