

QUICK MOVE-IN

FLOORPLAN
Black Cherry
COMMUNITY
Deerfield



4
Beds



2.5
Baths



2-Car
Garage



2362
Sq. Ft.

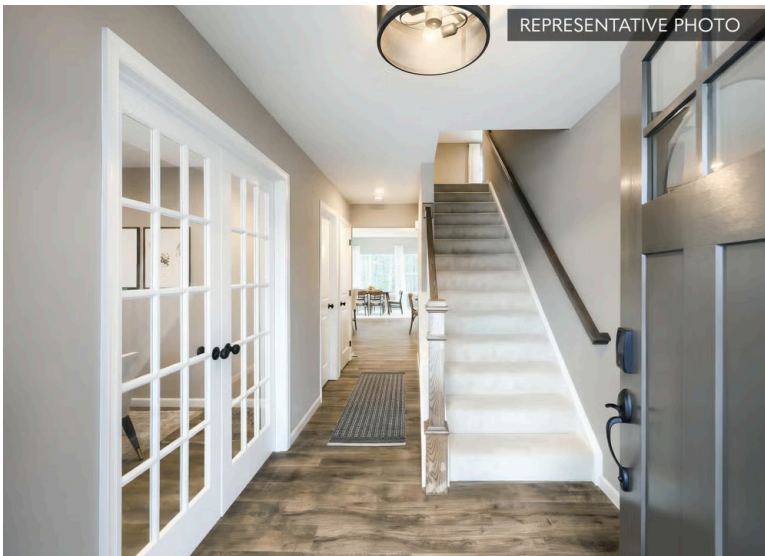

REPRESENTATIVE PHOTO

This thoughtfully designed two-story home offers open living spaces and practical upgrades throughout. The first floor features engineered vinyl plank flooring throughout and an open layout connecting the kitchen, morning room, and family room. The upgraded kitchen includes an island, quartz countertops, tile backsplash, upgraded cabinetry, stainless steel appliances, and recessed lighting. The family room is enhanced with upgraded windows and recessed lighting, bringing in natural light and added brightness. A morning room provides additional dining space and leads to a 10'x12' deck with steps, creating easy access to the backyard. The flex room has been converted to a private study with recessed lighting, offering a quiet space for work or hobbies. Upstairs, a spacious loft with recessed lighting...



REPRESENTATIVE PHOTO

Sales Office Hours

By Appointment: Open Wednesday - Saturday 10:00 am - 5:00 pm | Closed Sundays, Mondays, and Tuesdays



Have Questions? Ask...
KELLY

(484) 772-2693 / bhmarketing@berkshomes.com





FIRST LEVEL



Have Questions? Ask...
KELLY

(484) 772-2693 / bhmarketing@berkshomes.com





SECOND LEVEL

Have Questions? Ask...
KELLY

(484) 772-2693 / bhmarketing@berkshomes.com



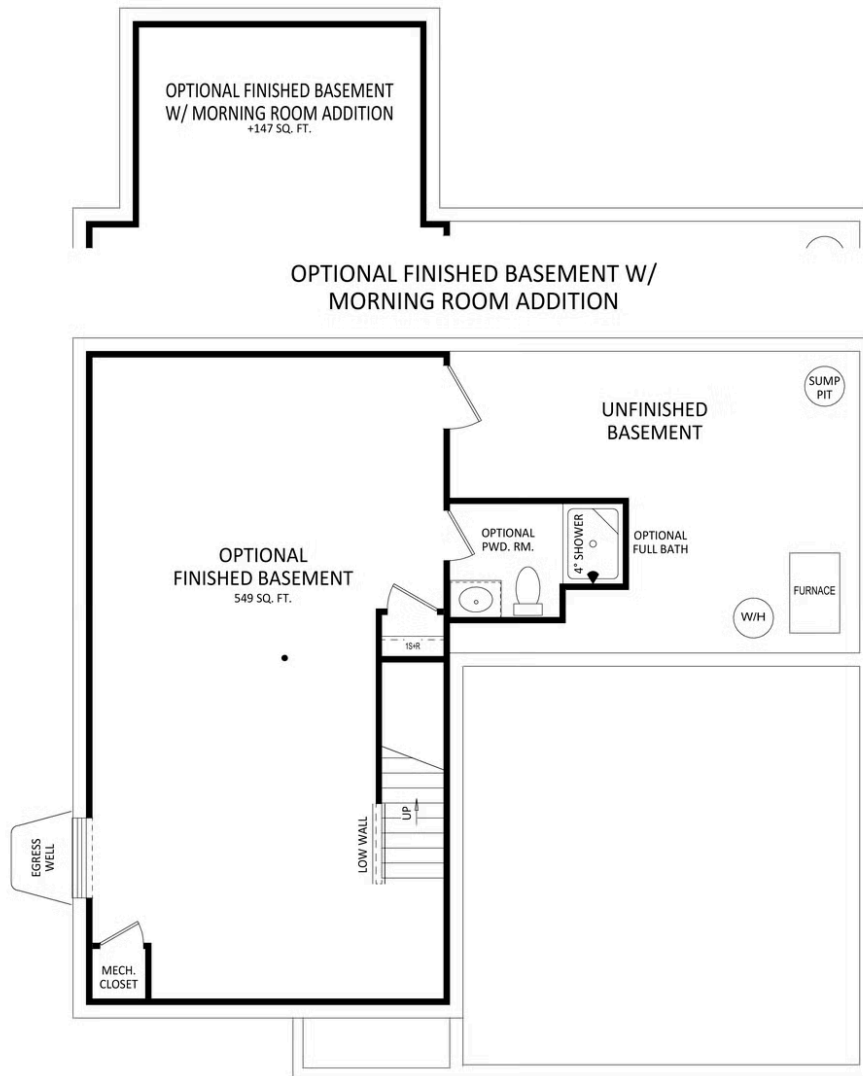

LOWER LEVEL



Have Questions? Ask...
KELLY

(484) 772-2693 / bhmarketing@berkshomes.com

