

## MODEL HOME

FLOORPLAN  
**Black Cherry**  
COMMUNITY  
**Seiders Hill**



4  
Beds



2.5  
Baths



2-Car  
Garage



3107  
Sq. Ft.



Step inside this 3,107 sq. ft. model home and discover a thoughtful layout designed for everyday living. The first floor features a bright, open kitchen enhanced with an island, quartz countertops, tile backsplash, upgraded cabinetry, stainless steel appliances, and recessed lighting. Just off the foyer, the flex room has been transformed into a dedicated study with added lighting—an ideal spot for work or organization. The family room includes upgraded windows and recessed lighting, creating a welcoming space that connects seamlessly to the kitchen and breakfast area.

Upstairs, a spacious loft offers added versatility, complete with recessed lighting. The private primary suite includes recessed lighting and a well-appointed bath with a...

### Sales Office Hours

Open Wednesday - Saturday 10:00 am - 5:00 pm | Closed  
Sundays, Mondays, and Tuesdays



Have Questions? Ask...  
**KELLY**

(484) 772-2693 / [bhmarketing@berkshomes.com](mailto:bhmarketing@berkshomes.com)





FIRST LEVEL



**Have Questions? Ask...**  
**KELLY**

(484) 772-2693 / bhmarketing@berkshomes.com





SECOND LEVEL



**Have Questions? Ask...**  
**KELLY**

(484) 772-2693 / [bhmarketing@berkshomes.com](mailto:bhmarketing@berkshomes.com)



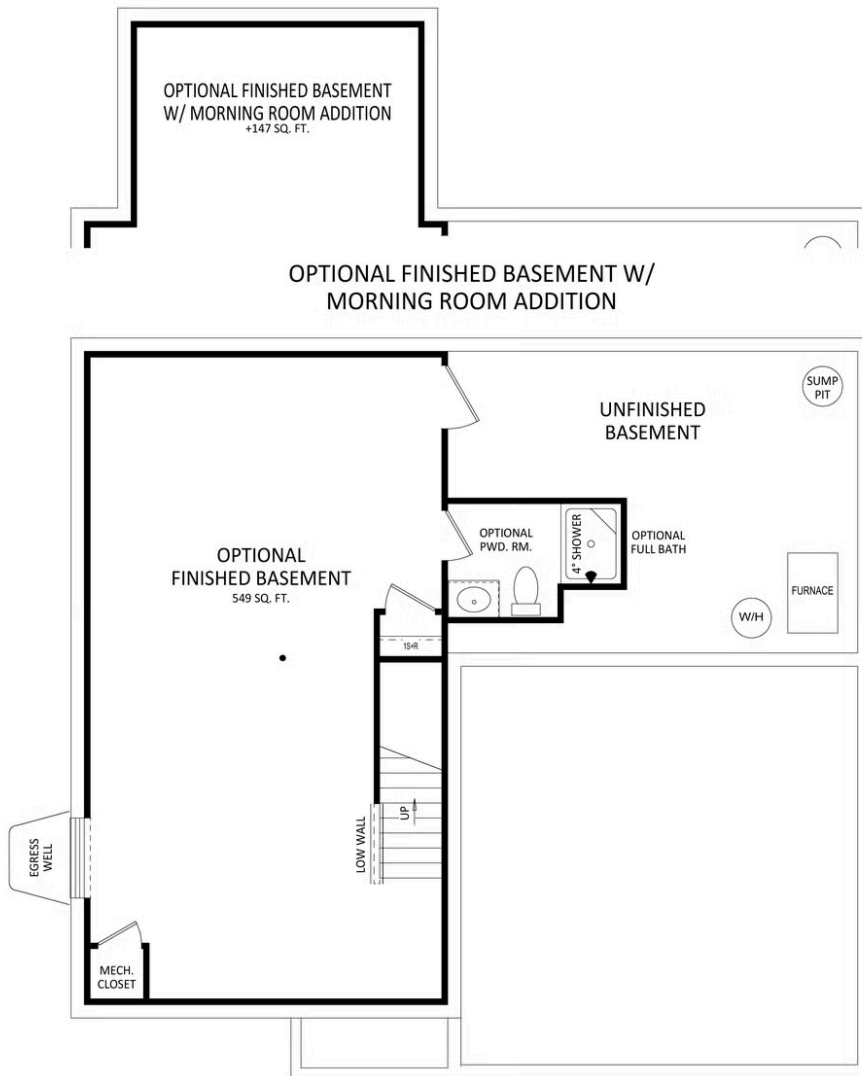

OPTIONAL FINISHED BASEMENT W/  
MORNING ROOM ADDITION

LOWER LEVEL



**Have Questions? Ask...**  
**KELLY**

(484) 772-2693 / [bhmarketing@berkshomes.com](mailto:bhmarketing@berkshomes.com)

