



UNDER CONSTRUCTION

FLOORPLAN
Black Cherry
COMMUNITY
Harvest Meadows



**4
Beds**



**2.5
Baths**



**2-Car
Garage**



**2362
Sq. Ft.**

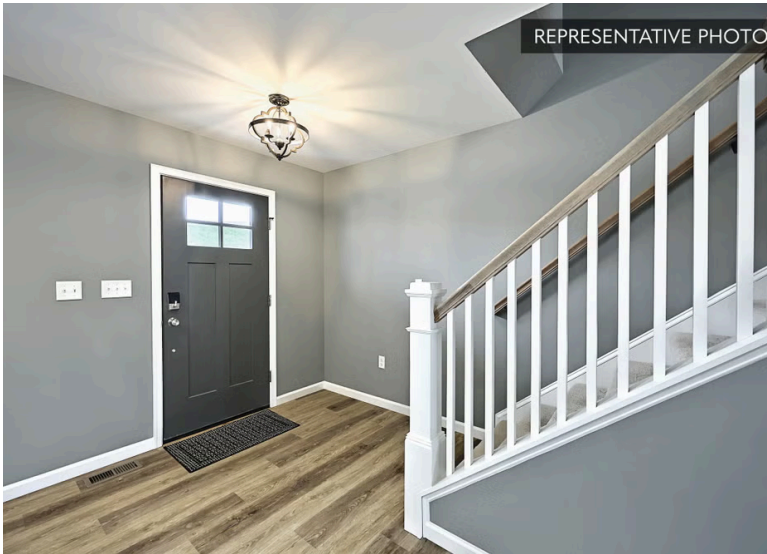

This thoughtfully designed two-story home offers space, style, and functionality with upgrades throughout.

The main level opens with a welcoming foyer that flows into the heart of the home. The upgraded kitchen features a center island, quartz countertops, tile backsplash, upgraded cabinetry, stainless steel appliances, and recessed lighting. Step outside to the composite deck, ideal for relaxing or entertaining. The kitchen and breakfast area flow into the spacious family room, enhanced with upgraded windows and recessed lighting. Engineered vinyl plank flooring runs throughout the first-floor living areas for a clean, cohesive look that's built to last. A private study off the foyer offers the ideal work-from-home setup, and a powder room and pantry round out the main level....



Bellefonte Area School District



Have Questions? Ask...
KELLY

(484) 772-2693 / bhmarketing@berkshomes.com





Have Questions? Ask...
KELLY

(484) 772-2693 / bhmarketing@berkshomes.com





Have Questions? Ask...
KELLY

(484) 772-2693 / bhmarketing@berkshomes.com



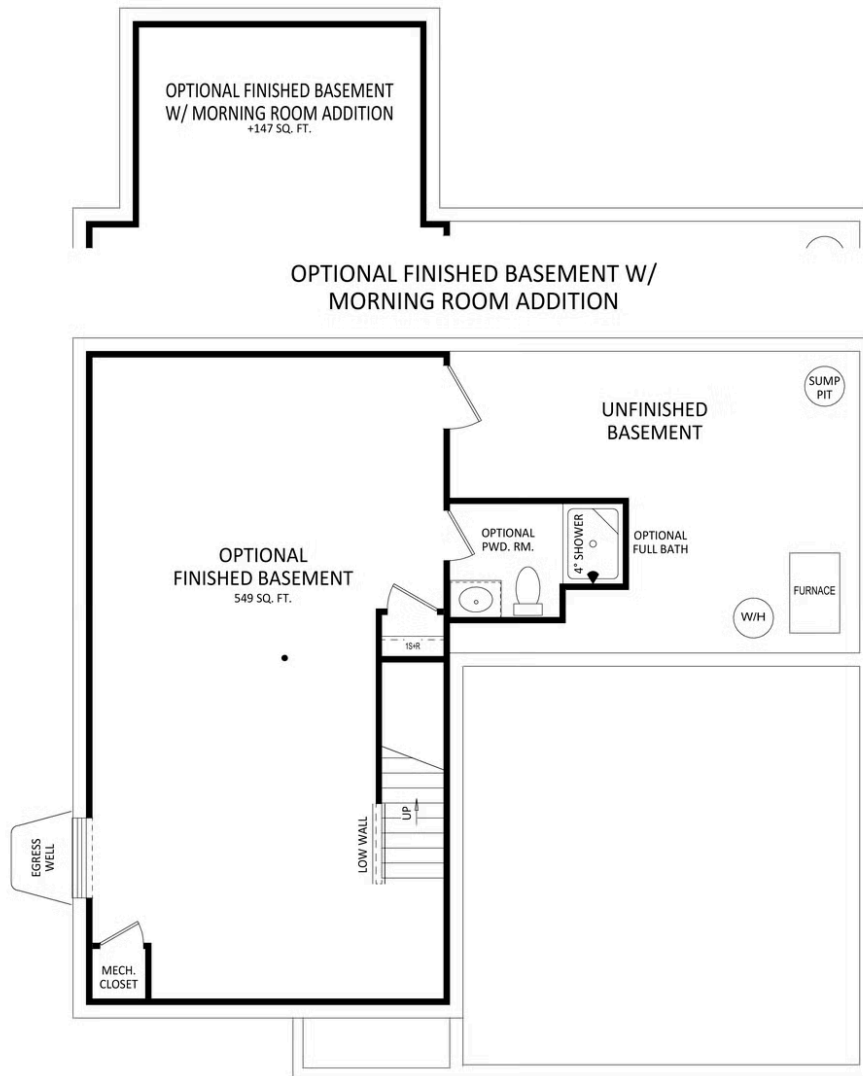

Have Questions? Ask...
KELLY

(484) 772-2693 / bhmarketing@berkshomes.com

