

# Sugar Maple

AVAILABLE IN 1 COMMUNITIES  
**Hills at Valley View**



**3  
Beds**



**2 -  
3.5  
Baths**



**2-Car  
Garage**



**1,328  
-  
1,944  
Sq. Ft.**

This 3-bedroom, 2-bath, one-story Sugar Maple is a beauty! You'll enjoy an open floorplan with a spacious family room that opens to a well-appointed kitchen with an eat-at-island. Two additional bedrooms and a primary suite boasting a sizeable bathroom and walk-in closet round out this impressive floorplan. Don't forget to finish the basement to add even more space for entertaining or relaxing with the family.



**Have Questions? Ask...**

**KELLY**

(484) 772-2693 / [bhmarketing@berkshomes.com](mailto:bhmarketing@berkshomes.com)





**Have Questions? Ask...**

KELLY

(484) 772-2693 / [bhmarketing@berkshomes.com](mailto:bhmarketing@berkshomes.com)



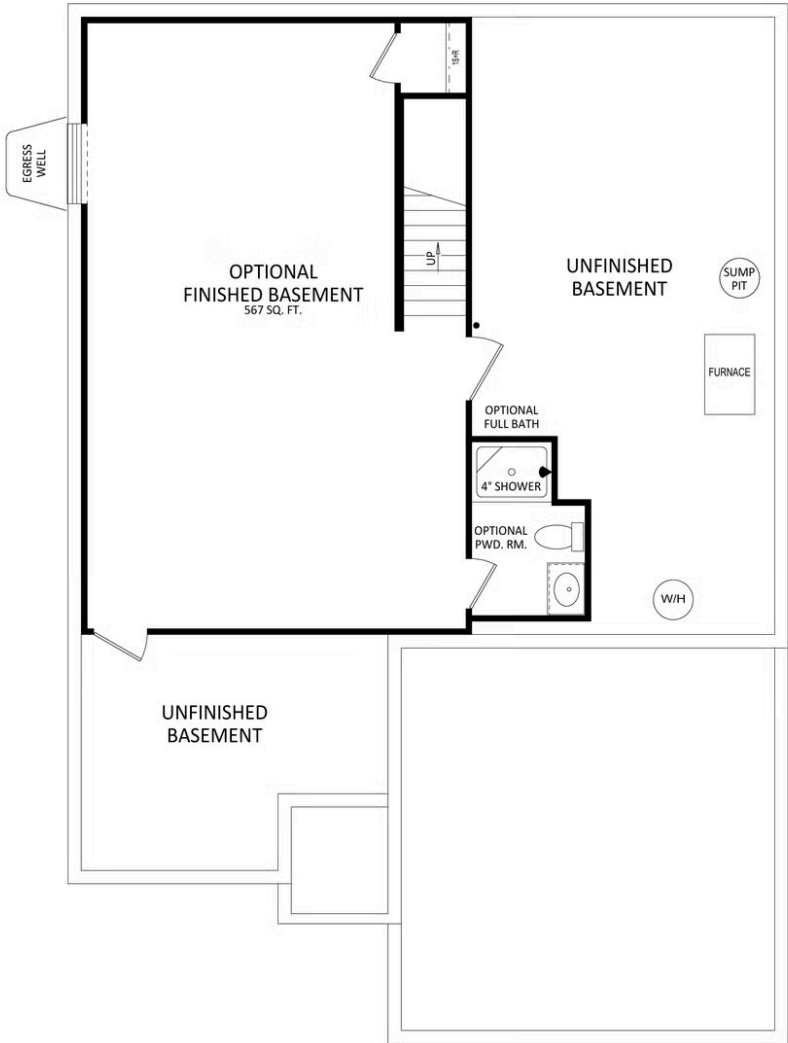

LOWER LEVEL



**Have Questions? Ask...**

KELLY

(484) 772-2693 / [bhmarketing@berkshomes.com](mailto:bhmarketing@berkshomes.com)

